

2017 REBA ANNUAL MEETING & CONFERENCE

Monday, November 6th
7:30 AM – 2:45 PM
DoubleTree Hotel
50 Ferncroft Road
Danvers, Mass.

Exhibitor & Sponsor Program

Fall is right around the corner and we are already gearing up for our 2017 Annual Meeting & Conference! Our AMC17 Exhibitor & Sponsor Program is a unique opportunity to showcase your company to a specific market of prospects. Each event draws upwards of 700 attendees, 50 exhibitors and a variety of sponsors.

In the enclosed brochure, you will find information on the Exhibitor and Sponsor program, including rates, benefits, registration forms and more!

Registration Deadline

~ October 30 ~

Deadline to Register as a
Conference Exhibitor/ Sponsor

Space is limited...register today!

Syllabus Ad Deadline

~ September 25 ~

Deadline for eighth-page sponsor ads
and quarter-page exhibitor ads to be
printed in the Conference Syllabus

Advertise in REBA News

To learn more, contact Scott Ziegler at
Massachusetts Lawyers Weekly:

scott.ziegler@lawyersweekly.com

(617) 218-8211

QUESTIONS?

For questions about the AMC17,
please contact Jessica Trenouth at
trenouth@reba.net or call the REBA
office at (617) 854-7555. You may
also visit us online at www.reba.net.



DOUBLETREE
BY HILTON™

50 Ferncroft Road
Danvers, Massachusetts

**NEW
VENUE!**

EXHIBITOR PACKAGES

★ Standard Exhibitor Package.....	\$ 775
★ Exhibitor Package for MLW Advertisers.....	\$ 575
★ Exhibitor Package for REBA Affinity Partners.....	\$ 375
★ Exhibitor Package for First-time Exhibitors.....	\$ 375

All Exhibitor Packages will include the following...

- Six-foot table with linen, two chairs, staff name-tags and free Wi-Fi
- Eighth-page black & white ad (3.5" W x 2" H) printed in the conference syllabus
- Company name and contact information printed in the conference syllabus
- Company information and booth location listed on registration handouts
- Mailing list of conference attendees, available electronically and in hard copy
- REBA e-news announcements promoting your company to REBA's 2,000+ members
- Exposure to up to 700 real estate and business professionals on the day of the event
- Exhibitor's marketing materials displayed on a table at conference registration

★ **Standard Exhibitor Package**

\$ 775

- This package includes all of the standard exhibitor benefits listed above.

★ **Exhibitor Package for MLW Advertisers**

\$ 575

- This package includes all of the standard exhibitor benefits listed above.
- To qualify for this discounted rate, the exhibiting company must be a current advertiser with *Massachusetts Lawyers Weekly (MLW)*. For more information, contact Scott Ziegler at *MLW* at scott.ziegler@lawyersweekly.com or at (617) 218-8211.

★ **Exhibitor Package for REBA Affinity Partners**

\$ 375

- This package includes all of the standard exhibitor benefits listed above.
- To qualify for this discounted rate, the exhibiting company must be a current and contracted REBA affinity partner. For more information on becoming an Affinity Partner, please contact Jessica Trenouth at trenouth@reba.net.

★ **Exhibitor Package for First-time Exhibitors**

\$ 375

- This package includes all of the benefits listed above.
- To qualify for this discounted rate, the exhibiting company must be a new/first-time exhibitor at REBA's semi-annual conferences.

In order to guarantee reservation, registration and payment must be received by October 30th

SPONSORSHIP PACKAGES

★ Breakout Room.....	\$1,500	★ Brochure.....	\$3,000
★ Break Area/Lounge.....	\$1,750	★ Luncheon.....	\$3,500
★ Registration Area.....	\$2,000	★ Lanyards.....	\$3,500
★ Gift to Attendees.....	\$2,500	★ Syllabus.....	\$4,000
		★ Tote-Bags.....	\$4,500

All Sponsor Packages will include the following...

- Exhibitor table, plus all of the standard benefits listed at the top of page two
- Eighth-page (3.5" W x 2" H) black & white ad printed in the conference syllabus
- Quarter-page (3.5" W x 4" H) black & white ad printed in the conference syllabus
- Mailing list of conference attendees, available electronically and in hard copy
- Sponsorship signage displayed in registration area, luncheon and around hotel
- Company logo and information displayed on the REBA web site

★ **Breakout Room Sponsorship** *(multiple available)* **\$ 1,500**

- All standard benefits listed at the top of page three
- 15% off rate for an eighth-page, full-color ad in the next edition of *REBA News*
- Two complimentary conference registration passes
- REBA membership mailing list, available electronically (single use)
- Sponsor's marketing materials displayed on a table inside your sponsored breakout room

★ **Break Area/Lounge Sponsorship** *(multiple available)* **\$ 1,750**

- All standard benefits listed at the top of page three
- 50% rate for an eighth-page, full-color ad in the next edition of *REBA News*
- Two complimentary conference registration passes
- REBA membership mailing list, available electronically (single use)
- Sponsor's marketing materials displayed at sponsored break area/lounge

★ **Conference Registration Sponsorship** **\$ 2,000**

- All standard benefits listed at the top of page three
- 50% rate on an eighth-page, full-color ad in the next edition of *REBA News*
- Two complimentary conference registration passes
- REBA membership mailing list, available electronically (single use)
- Sponsor's marketing materials displayed at the Conference registration table

★ **Gift to Attendees Sponsorship** *(multiple available)* **\$ 2,500**

- All standard benefits listed at the top of page three
- Customizable gift with your company name and logo, given to every attendee at registration
- Eighth-page, full-color ad in the next edition of *REBA News*
- Two complimentary conference registration passes
- REBA membership mailing list, available electronically (single use)

In order to guarantee reservation, registration and payment must be received by October 30th

SPONSORSHIP PACKAGES

★ Brochure Sponsorship

\$ 3,000

- All standard benefits listed at the top of page three
- Exclusive marketing opportunities in Conference Brochure
- Special “thank-you” recognizing sponsorship in Conference Attendees Brochure
- Eighth-page, full-color ad in the next edition of *REBA News*
- Two complimentary conference registration passes
- REBA membership mailing list, available electronically (single use)

★ Luncheon Sponsorship

\$ 3,500

- All standard benefits listed at the top of page three
- Exclusive marketing opportunities at the seat of every attendee at the luncheon
- Special “thank-you” from the REBA President during the luncheon address
- Quarter-page, full-color ad in the next edition of *REBA News*
- Two complimentary conference registration passes
- REBA membership mailing list, available electronically (two uses)

★ Lanyards Sponsorship

\$ 3,500

- All standard benefits listed at the top of page three
- Customized lanyards with your company name & logo given to attendees at registration
- Full-page, full-color ad on the back, inside cover of every conference syllabus
- Eighth-page, full-color ad in the next edition of *REBA News*
- Two complimentary conference registration passes
- REBA membership mailing list, available electronically (two uses)

★ Syllabus Sponsorship

\$ 4,000

- All standard benefits listed at the top of page three
- Full-page, full-color ad on the back, outside cover of every conference syllabus
- Quarter-page, full-color ad in the next edition of *REBA News*
- Four complimentary conference registration passes
- REBA membership mailing list, available electronically (two uses)
- Sponsor’s marketing materials displayed on a table in the conference registration area

★ Tote Bag Sponsorship

\$ 4,500

- All standard benefits listed at the top of page three
- Customized tote bags with your company name and logo given to every attendee at registration
- Full-page, full-color ad on the front, inside cover of every conference syllabus
- Half-page, full-color ad in the next edition of *REBA News*
- Four complimentary conference registration passes
- REBA membership mailing list, available electronically (two uses)
- Sponsor’s marketing materials displayed on a table in the conference registration area

In order to guarantee reservation, registration and payment must be received by October 30th

GENERAL INFORMATION

- ★ **Cancellation Policy:** Registrations cancelled in writing on or before 10/31/17 will be honored but charged a \$50 processing fee. Refunds will not be honored if cancellations are received after 10/31/17, or if a company registers but does not attend the event.
- ★ **Affinity Partner Rate:** To qualify for this discounted rate, the exhibiting company must be a current and contracted affinity partner of REBA. For more information on becoming an Affinity Partner, please contact Jessica Trenouth at trenouth@reba.net.
- ★ **First-Time Vendor Rate:** To qualify for this discounted rate, the exhibiting company must be a new/first-time exhibiting company of the Real Estate Bar Association's Conferences. For more information on this rate, please contact Jessica Trenouth at trenouth@reba.net.
- ★ **Vendor Boxed Lunch:** Available for \$20 per person and must be pre-ordered; includes breakfast items and snacks available throughout day at break stations, as well as a boxed lunch, with your choice of a roast beef, turkey or grilled eggplant, tomatoes and mozzarella sandwich. All boxed lunches include deli chips, whole fresh fruit and a freshly baked cookie. Beverages are provided at the break stations.
- ★ **Exhibitor/Sponsor Table Set-up:** All exhibitors and sponsors will be equipped with a 6' table, table linen and skirt (you are also welcome to bring your own if preferred), two chairs and staff name-tags. You are welcome to bring stands, tripods, etc. to display banners and signs. The Hotel does not allow taping, gluing, stapling, tacking or affixing of any kind without prior approval.
- ★ **Raffle Prize (optional):** Exhibitors are welcome to offer a raffle prize to help drive traffic to their table. Participating companies are responsible for all raffle prizes and for the selection of the winner at the time of drawing. REBA Foundation and the hotel are not responsible for any lost or stolen items.

★ EXHIBITOR TABLE LOCATIONS ★

On the enclosed registration form, please indicate your top three table location preferences from the floor plan below. Table locations are available on a first-come, first-served basis, once payment is received.

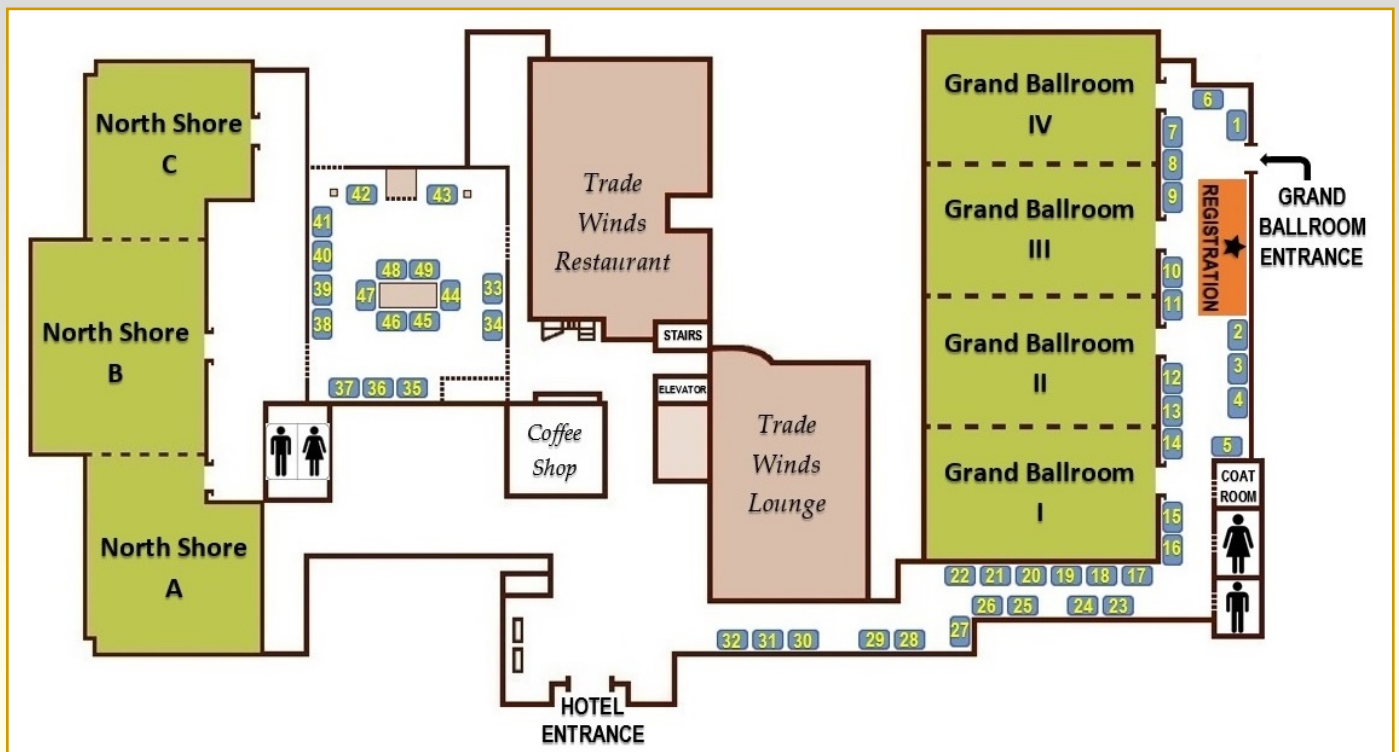

2017 REBA Annual Meeting & Conference
Monday, November 6, 2017 ♦ DoubleTree Hotel, Danvers

EXHIBITOR REGISTRATION FORM

CONTACT INFORMATION

Company Name as appears in print: _____
 Primary service or product: _____
Contact: _____ Email: _____
 Address: _____ City State Zip: _____
 Web site: _____ Tel: _____ Cell: _____

STANDARD EXHIBITOR PACKAGES

Exhibitor Packages	Rate	Total
Standard Exhibitor Package	\$ 775 per table	
Exhibitor Package with a MLW Advertising Discount	\$ 575 per table	
Exhibitor Package for REBA Affinity Partners	\$ 375 per table	
Exhibitor Package for First-Time Vendors	\$ 375 per table	
Boxed Lunch (please indicate quantities below): ___ Roast beef with boursin & caramelized onions on rosemary focaccia ___ Roasted turkey with cranberry & tarragon mayo on a baguette ___ Grilled eggplant, tomatoes & buffalo mozzarella on a baguette	\$ 20 per lunch <i>(includes chips, fruit & freshly-baked cookie)</i>	

TOTAL: \$ _____

ADDITIONAL INFORMATION

Table Location - Indicate your preferred table locations from the exhibitor floor plan: _____
Exhibitor Staff - Include names of all staff members (6 max): _____

Competitors - If possible, please try not to locate our table next to: _____

PAYMENT

Once registration and payment is received, you will receive an email confirmation, which will serve as your receipt. Please remit payment to: REBA Foundation, Inc. 295 Devonshire Street, Sixth Floor, Boston, MA 02110, or to trenouth@reba.net. Checks should be made payable to: REBA Foundation, Inc. Tax ID No. 04-3395832

Credit Card

Credit Card No: _____ Exp. Date: _____ / _____
 Signature: _____ Date: _____ / _____

Check Enclosed

Check No: _____
 Date: ____ / ____ / ____

Registration Deadline: Registrations and payment must be received on or before 10/30/17 in order to guarantee a table and/or sponsorship at the conference, and in order for your company information and ad to be printed in the conference syllabus. REBA reserves the right to cancel any table assignment or sponsorship as needed due to non-payment.
Cancellation Policy: Exhibitor and sponsor registrations cancelled in writing on or before 10/30/17 will be honored, but charged a \$50 processing fee. Refunds will not be honored if written cancellations are received after 10/30/17, or if a company pre-registers for the conference but does not attend, or if a company pre-registers for the conference but does not pay the registration fee.

2017 REBA Annual Meeting & Conference
Monday, November 6, 2017 ♦ DoubleTree Hotel, Danvers

SPONSORSHIP REGISTRATION FORM

CONTACT INFORMATION

Company Name as appears in print: _____
 Primary service or product: _____
Contact: _____ **Email:** _____
Address: _____ **City State Zip:** _____
Web site: _____ **Tel:** _____ **Cell:** _____

SPONSORSHIP PACKAGES

Sponsorship Packages	Rate	Total
Breakout Session Room	\$ 1,500 per room	
Break Station Area	\$ 1,750 per area	
Conference Registration Area	\$ 2,000	
Conference Gift	\$ 2,500 per gift	
Conference Brochure	\$ 3,000	
Conference Luncheon	\$ 3,500	
Conference Lanyards	\$ 3,500	
Conference Syllabus*	\$ 4,000	
Conference Tote-Bags*	\$ 4,500	
Boxed Lunch (please indicate quantities below): ___ Roast beef with boursin & caramelized onions on rosemary focaccia ___ Roasted turkey with cranberry & tarragon mayo on a baguette ___ Grilled eggplant, tomatoes & buffalo mozzarella on a baguette	\$ 20 per lunch <i>(includes chips, fruit & freshly-baked cookie)</i>	

*No longer available

TOTAL: \$ _____

ADDITIONAL INFORMATION

Table Location - Indicate your preferred table locations from the exhibitor floor plan: _____

Exhibitor Staff - Include names of all staff members (6 max): _____

Competitors - If possible, please try not to locate our table next to: _____

PAYMENT

Once registration and payment is received, you will receive an email confirmation, which will serve as your receipt. Please remit payment to: REBA Foundation, Inc. 295 Devonshire Street, Sixth Floor, Boston, MA 02110, or to trenouth@reba.net. Checks should be made payable to: REBA Foundation, Inc. Tax ID No. 04-3395832

Credit Card

Credit Card No: _____ Exp. Date: _____ / _____
 Signature: _____ Date: _____ / _____

Check Enclosed

Check No: _____
 Date: _____ / _____ / _____

Registration Deadline: Registrations and payment must be received on or before 10/30/17 in order to guarantee a table and/or sponsorship at the conference, and in order for your company information and ad to be printed in the conference syllabus. REBA reserves the right to cancel any table assignment or sponsorship as needed due to non-payment.

Cancellation Policy: Exhibitor and sponsor registrations cancelled in writing on or before 10/30/17 will be honored, but charged a \$50 processing fee. Refunds will not be honored if written cancellations are received after 10/30/17, or if a company pre-registers for the conference but does not attend, or if a company pre-registers for the conference but does not pay the registration fee.